

SCUBAPRO

Technical Service Schematic

MK 10 FIRST STAGE #10-500-000
MK 9 FIRST STAGE #10-400-000

Date 12/97 Revision C
Annual Repair Parts Kit #10-500-041

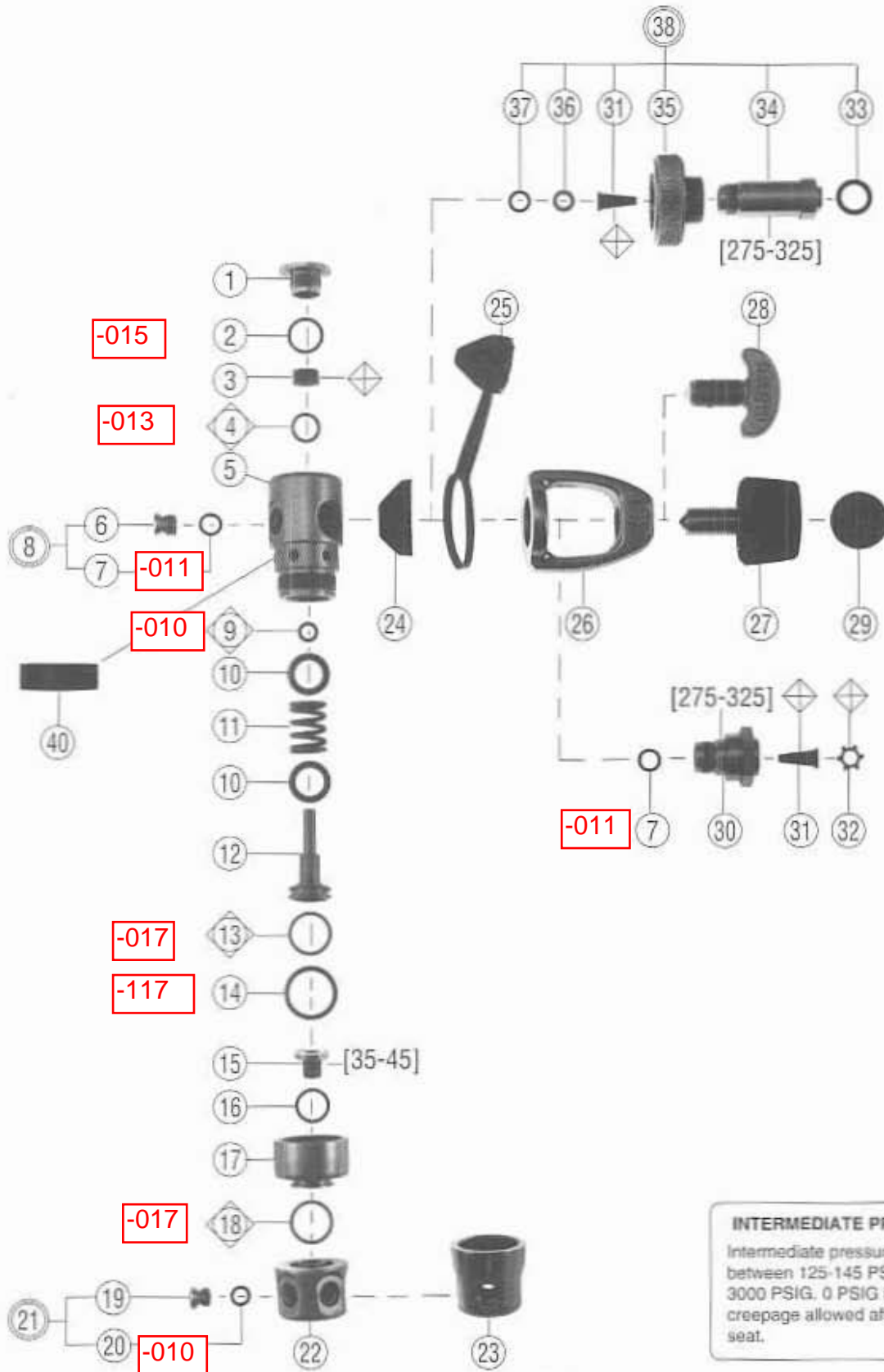

INTERMEDIATE PRESSURE LIMITS

Intermediate pressure limits must be between 125-145 PSIG at both 300 and 3000 PSIG. 0 PSIG intermediate pressure creepage allowed after seating of new seat.

SCUBAPRO

Technical Service Schematic

MK 10 FIRST STAGE #10-500-000
MK 9 FIRST STAGE #10-400-000

Date 12/97 Revision E
 Annual Repair Parts Kit #10-500-041

Parts

#	QTY	PART #	DESCRIPTION	COST		
1	1	10-101-106	SEAT RETAINER			
2	1	01-050-157	O-RING, SEAT RETAINER, RED			
3	1	10-101-151	SEAT, HP, CAVE CONE			
*	4	01-050-147	O-RING, HP SEAT, PURPLE			
5	1	10-500-108	BODY, MK10, MK9			
6	2	10-101-139	HP PLUG, 7/16-20			
7	3	01-050-138	O-RING, HP PLUG, YOKE RTNR, BLUE			
8	2	10-101-039	HP PLUG, 7/16-20 WITH O-RING			
9	1	01-050-137	O-RING, PISTON SHAFT, AMBER			
*	10	01-060-101	WASHER			
11	1	01-020-217	SPRING			
12	1	10-500-003	PISTON			
13	1	01-050-162	O-RING, PISTON, LARGE, AMBER			
14	1	01-050-217	O-RING, CAP, BLUE			
15	1	0	10-500-103	SWIVEL RETAINER		
16	1	0	01-060-500	WASHER, SWIVEL		
17	1	0	10-500-101	CAP, SWIVEL		
18	1	0	01-050-161	O-RING, SWIVEL, BLUE		
19	4	4	10-101-104	LP PLUG, 3/8-24		
20	4	4	01-050-132	O-RING, LP PLUG, BLUE		
21	4	4	10-101-006	LP PLUG, 3/8-24 WITH O-RING		
22	1	0	10-500-102	SWIVEL, 5-PORT		
23	0	1	10-400-105	CAP, NON SWIVEL, 5-PORT		
24	1	1	10-400-103	SADDLE		
25	1	1	10-101-211	HP PROTECTOR		
26	1	1	10-101-131	YOKE, 9/16, POLISHED		
27	1	1	10-200-008	YOKE SCREW ASSY, 9/16		
28	1	1	10-101-132	YOKE SCREW, 9/16, (OLD STYLE)		
29	1	0	01-006-510	DECAL, MK10		
30	1	1	10-400-104	YOKE RETAINER		
31	1	1	01-028-109	FILTER, CONICAL		
32	1	1	01-073-101	FILTER RETAINER		
33	1	1	01-050-193	O-RING, DIN ADAPTER, BLACK		
34	1	1	10-400-107	RETAINER, DIN, 300 BAR		
35	1	1	10-105-118	KNOB, 300 BAR		
36	1	1	01-060-501	WASHER, DIN		
37	1	1	01-050-142	O-RING, DIN RETAINER, AMBER		
○	38	1	1	10-400-030	KIT, DIN, 300 BAR	
○	40	1	1	10-500-105	SPEC BOOT, MK10, MK9	
○	●	1	1	10-500-020	SPEC BOOT KIT W/SILICONE GREASE	
○	●	1	1	10-500-021	E.A.N., CONVERSION KIT (NITROX)	
		MK10 #10-500-000				
		MK9 #10-400-000				

Technical Information:

Special Engineering Notes:

Item #4, 01-050-147 o-ring can be installed with the aid of a 3/8" nut driver. To properly locate this o-ring, lightly lubricate it, then place it into the body and chase it with the end of the nut driver to fully seat it. Apply a light downward pressure using a rocking action. Remove the nut driver and inspect the o-ring position. It should be located completely into the recess.

Maximum of 3 washers #01-060-101 may be used to adjust intermediate pressure to specified limits.

Flow through piston designs will under some conditions make a whistling noise during flow. To alleviate, replace Item #3 HP seat, and heavily lubricate Item #9, 01-050-137 o-ring.

Legend (prices subject to change without notice)

- Not Shown ◇ Dynamic O'Ring Replace Annually
- Optional Item ◊ Annual Replacement
- ▲ Limited Warranty [] Torque In Inch Pounds
- Older Configuration * See Note